

# CASA PADELLÀS

- 1 Reception and ticket sales
- 2 Shop
- 3 Audioguides
- 4 Casa Padellàs courtyard.  
Temporary exhibition rooms
- 5 Access to Museum visit
- 6 Prehistory of the Plain  
of Barcelona
- 7 The origins of Barcelona
- 8 Audiovisual presentation
- 9 Lift  
(access to the archaeological  
subsoil of the Plaça del Rei)

■ Area closed to the public

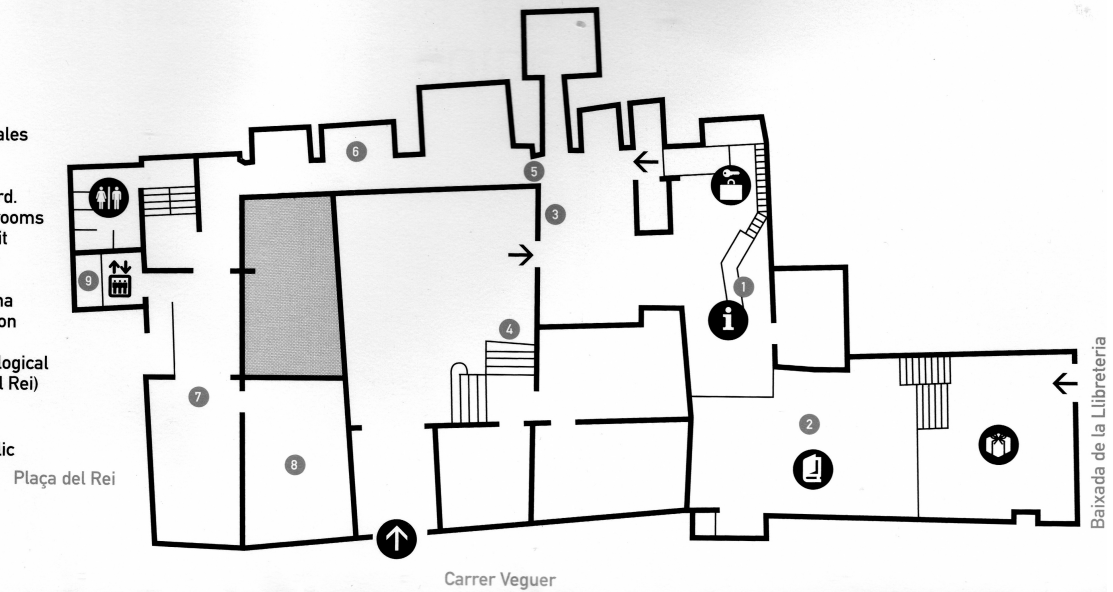

# ARCHAEOLOGICAL SUBSOIL

- 1 Start of the route around  
the archaeological subsoil
- 2 *Barcino*. Roman Barcelona:  
how people lived
- 3 Laundry and dying  
workshop. *Fullonica* and  
*tinctoria* (second half of 2nd  
century AD)
- 4 Salted fish and *garum*  
factory.  
Cetaria (3rd century AD)
- 5 Winemaking facilities  
(second half of 3rd century  
– early 4th century AD)
- 6 Church from the Visigoth  
period (6th century)
- 7 The Episcopal complex  
of Barcelona  
(4th–7th centuries)

■ Route for visitors

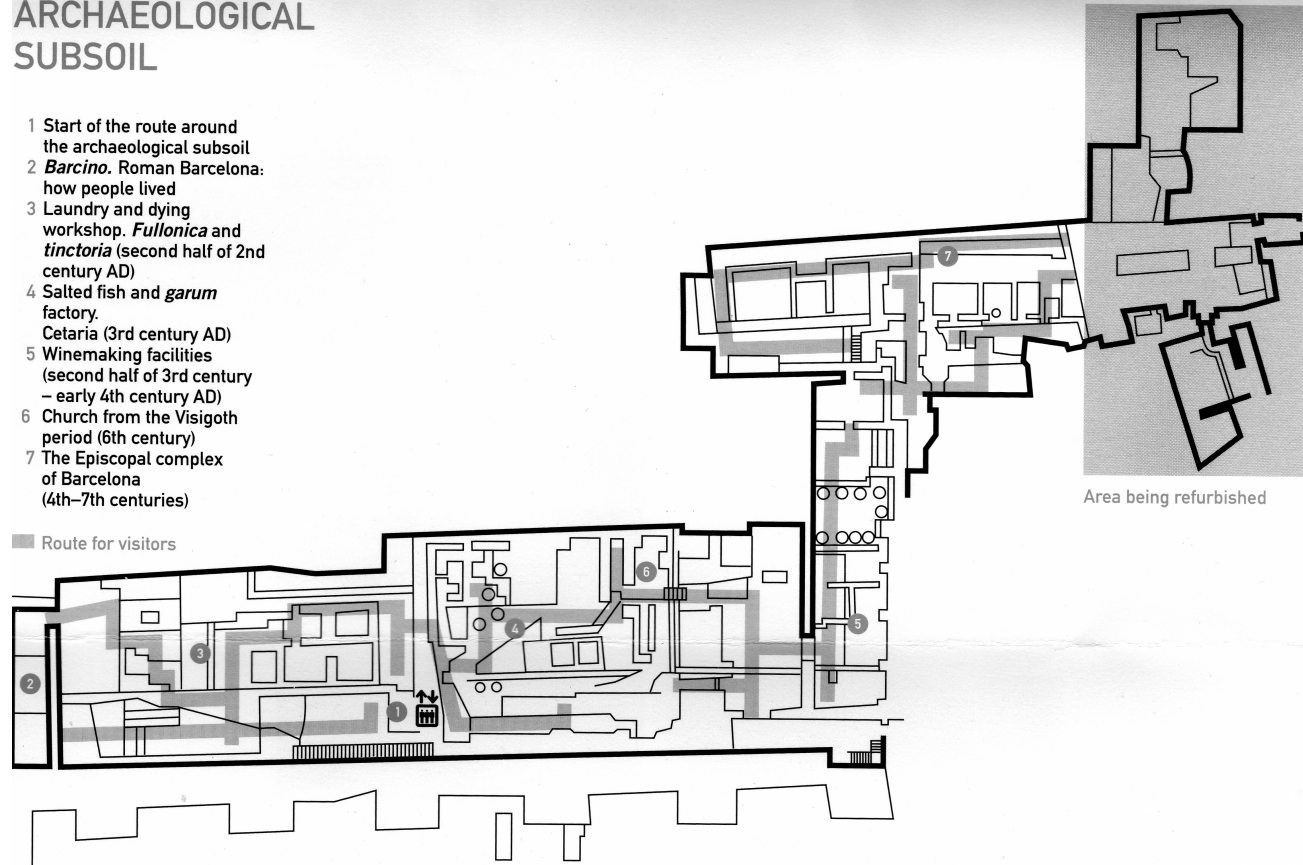

## COUNT'S/ ROYAL PALACE

## BARCELONA IN THE MIDDLE AGES (8th-13th centuries)

- A** 3-D reconstruction:  
From the Visigoth Count's  
Palace (6th century) to the  
Count's/Royal palace  
(14th century)
- B** Interactive model of the  
city of Barcelona in the  
late 13th century
- 8** Barcelona and the  
Mediterranean world
- 9** Barcelona and its  
inhabitants
- 10** Work in the city
- 11** House and home
- 12** The city markets
- 13** Church and city
- 14** Life and death:  
sickness and medicine
- 15** Life at the palace
- 16** Access to the Tinell Hall  
and Chapel of St Agatha
- 1** From Visigoth Barcelona  
to Moslem Barcelona
- 2** Medina Barshaluna. The  
rapid Umayyad expansion
- 3** Barcelona between two  
worlds (9th-10th centuries):  
the Carolingian conquest
- 4** The formation of the  
mediaeval city.  
Towards the capital of a  
Mediterranean empire
- 5** Barcelona looks to the  
sea
- 6** The growth of the city and  
the process of fortification
- 7** City government.  
County organisation and  
municipal institutions.  
Barcelona and Catalonia

Archaeological  
subsoil

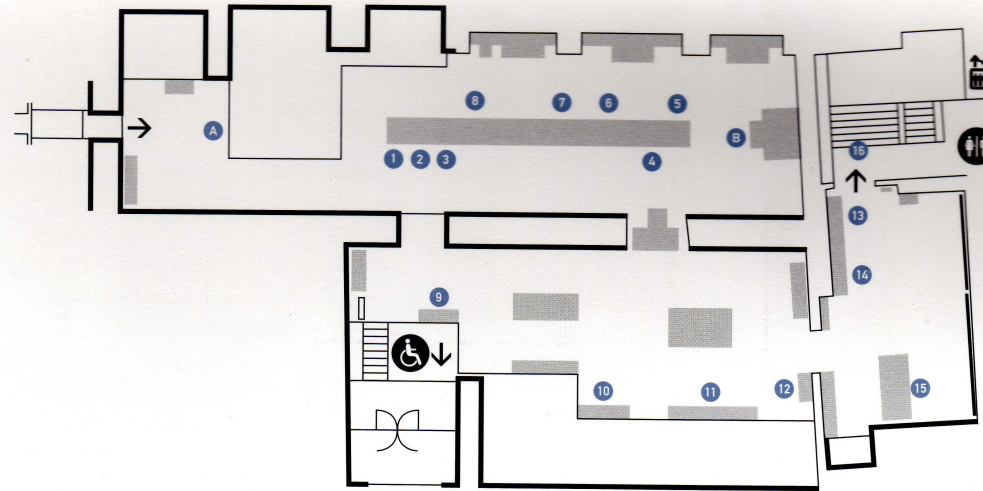

Plaça del Rei

## GREATER ROYAL PALACE

## TINELL HALL AND ST AGATHA'S CHAPEL

- 1** Tinell Hall
- 2** St Agatha's Chapel
- 3** Access to the Martí  
l'Humà conference room
- 4** Exit

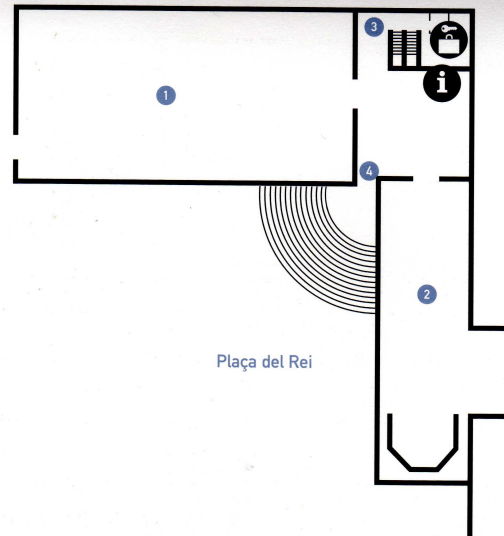

Plaça del Rei

Via Laietana